

# OR-SNAPPAR-2400 Adapter for Infiltrator™ Tanks

## Before You Begin

These instructions explain how to install an Orenco OR-SNAPPAR-2400 Tank Adapter onto an Infiltrator tank for use with a nominal 24in (600mm) riser (Orenco FRP or PVC riser, including ultra-rib-style PVC). This document provides separate [Adapter-to-Tank Installation](#) and [Riser-to-Adapter Installation](#) instructions. Before beginning, read these instructions and any documents referenced in them.



**IMPORTANT** — Orenco strongly recommends watertightness testing of all riser-to-tank connections after installation.

## Adapter-to-Tank Installation

Step 2a

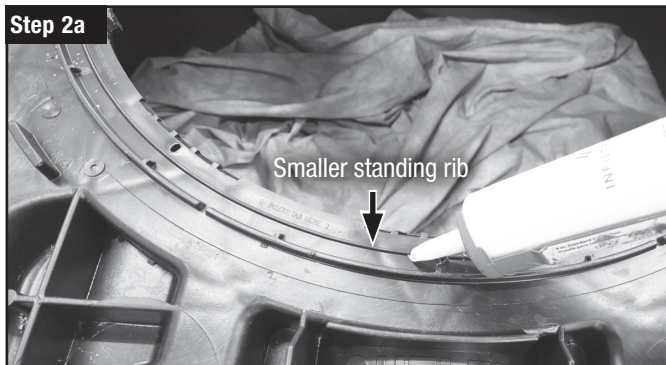

Step 2b

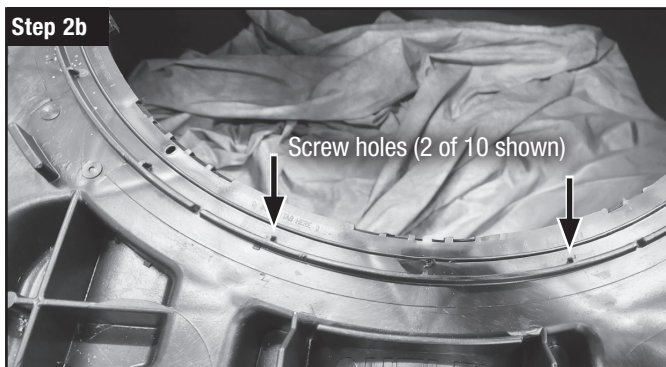

Step 2c

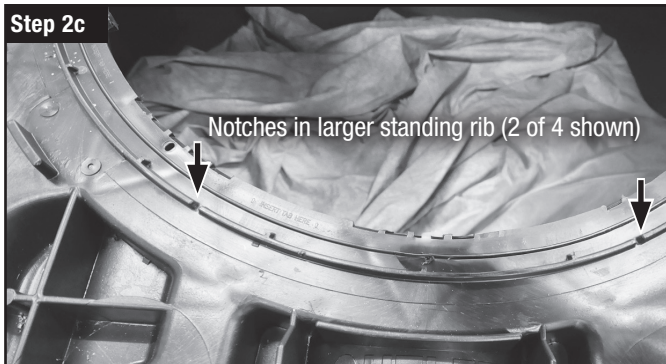

## Step 1. Gather Required and Materials

Gather the following tools and materials for installing the adapter onto the tank:

- SSS-1410HEX hardware kit (10 #14 2in stainless steel hex anchor screws), typically included with tank
- Caulking gun
- ADH200 sealant (ISI-1500 is also acceptable)
- Drill, preferably cordless
- 3/8in hex nut driver drill bit

For more information on adhesives, including working times and cure times, see [Adhesives and Dispensers for Orenco Products Technical Data Sheet, NTD-GOP-ADH-1](#).

## Step 2. Apply Sealant

**Step 2a.** Apply two continuous 3/8in (10mm) beads of adhesive sealant to the smaller of the two standing ribs closest to the pilot holes on the top surface of the tank opening.

- Sealant thickness must fill the gap beneath where the adapter will be installed.

**Step 2b.** Add an extra dab of sealant into each of the 10 screw holes.

**Step 2c.** Add a generous dab of sealant into each of the four notches in the larger standing rib.

## Step 3. Place Adapter

**Step 3a.** Align the adapter with the tank opening by lining up one of the arrows on the adapter with the arrow on the tank inlet or outlet.

**Step 3b.** Center and press the adapter to create an even distribution of the sealant.

- When properly aligned, the adapter is seated tightly on the tank.

## Adapter-to-Tank Installation

### Step 4b

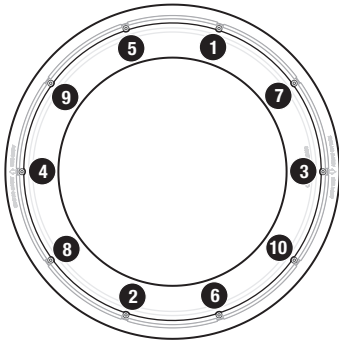

### Step 4. Fasten Adapter

**Step 4a.** Partially drive all 10 stainless steel screws into the pilot holes, but do not fully tighten.

**Step 4b.** Tighten the screws in an alternating opposing pattern around the adapter until all are snug.



**IMPORTANT** — Do not overtighten the screws.

## Riser-to-Adapter Installation



**Note** — Orenco recommends backfilling around the riser with 3/8in (10mm) pea gravel or similar granular material for installations in cold weather areas to prevent frost heave.

### Step 1. Gather Tools and Materials

Gather the following tools and materials for installing the riser onto the adapter:

- Sanding pads, 40-grit
- Clean cloth rags or paper towels
- Acetone or alcohol
- Methacrylate adhesive\*
- ADH200 adhesive\*
- Putty knife or tongue depressor
- Secondary safety barrier, such as the Orenco Tank Shield®, optional†

\* For more information on adhesives, including working times and cure times, see [Adhesives and Dispensers for Orenco Products Technical Data Sheet, NTD-GOP-ADH-1](#).

† For more information on the Orenco Tank Shield, see [Orenco Tank Shield Technical Data Sheet, NTD-GOP-RSG-1](#).

### Step 2. Prep Bonding Surfaces

**Step 2a.** Roughen the bonding surfaces on the adapter and riser with the sanding pads.

**Step 2b.** Use a clean rag or paper towel and acetone or alcohol to wipe off the bonding surfaces of the adapter and the riser.

**Step 2c.** Let the bonding surfaces dry completely.

- The bonding surfaces must be clean and dry for a good fit and for creating a watertight joint.

## Riser-to-Adapter Installation

### Step 3. Install the Riser

**Step 3a.** Apply a bead of methacrylate adhesive to the outside of the adapter.

**Step 3b.** Place the riser, aligning any penetrations correctly.

**Step 3c.** Firmly press the riser onto the adapter until the bottom of the riser is resting on the adapter flange.

**Step 3d.** Twist the riser back and forth slightly to fully seat it and to create a good bond.

- Make sure any penetrations remain aligned.

**Step 3e.** Inside the riser, apply a continuous bead of ADH200 adhesive to the joint between the adapter opening and the riser.

**Step 3f.** Use a putty knife, tongue depressor, or clean cloth to create a smooth, continuous fillet along the joint.

**Step 3g.** Make sure there are no voids in the ADH200 adhesive fillet.

**Step 3h.** Wait 12 hours for the ADH200 to set before handling.

### Step 4. Test for Watertightness



**IMPORTANT** — A watertight tank and watertight riser-to-tank connections are critical for the wastewater system to function effectively and efficiently.

**Step 4a.** Let all adhesives cure completely before continuing. This is 2-3 days for the ADH200.

For more information on adhesives, see [Adhesives and Dispensers for Orenco Products Technical Data Sheet, NTD-GOP-ADH-1](#).

**Step 4b.** Refer to one of the following documents for testing watertightness:

- [Orenco Fiberglass Riser Installation Instructions, NIN-RLA-RF-1](#)
- [PVC Riser Installation Instructions, NIN-RLA-RR-1](#)

### Step 5. Install Secondary Safety Barrier



**IMPORTANT** — Orenco strongly recommends that all tank risers 12in (300mm) and larger in diameter be equipped with a secondary safety barrier such as the Orenco Tank Shield to help prevent falls or unintended entry.

See [Tank Shield Field Retrofit Instructions, NIN-GOP-RSG-2](#) for information on installing the Orenco Tank Shield.

