

HDA-Style Discharge Assemblies with Pumps Installation Instructions

Step 1. Install Mounting Plate Assembly

Install the mounting plate assembly in the riser or basin before you attach the riser to the tank or install the basin.

- Access riser:
 - If the assembly hasn't been installed, perform Step 1.
 - If the assembly has been installed, go to Step 2.
- Pump basin:
 - If the assembly hasn't been installed, see the system's plan set to determine the discharge hole height, then perform Step 1.
 - If the assembly has been installed, go to Step 2.

Step 1a. Measure and mark the location on the outside of the riser or basin for the center of the simplex discharge hole or the on-center point for the duplex discharge holes.

- Access riser: Measure from the tank end of the riser.
 - Concrete or M-Series tanks: 8in (203mm)
 - Roth tanks: 11in (279 mm)
- Pump basin: Measure from the access lid end of the basin.

Step 1b. Drill the hole in the riser or basin, centered on the mark.

- Simplex hole diameter: 2-1/8in (54mm)
- Duplex hole diameter: 1-7/8in (48mm), 5-1/2in (140mm) on center

Step 1c. Deburr the discharge hole.

Step 1d. Roughen the contact surfaces on the inside of the riser or basin around the discharge hole and the HDA mounting plate.

Step 1e. Use a clean rag and acetone to wipe the roughened contact surfaces on the riser or basin and the mounting plate.

Step 1f. Apply methacrylate adhesive to the mounting plate.

- Begin at the discharge stub.
- Work the adhesive bead outward in a spiral pattern all the way around the edges of the mounting plate.

Step 1g. Press the mounting plate assembly into the discharge hole, with the quick-connect's open end toward the top of the riser or basin.

Step 1h. Use the four stainless steel screws that are supplied with the HDA to secure the mounting plate assembly at each corner.

Step 1i. Add a bead of methacrylate adhesive around the seam between the mounting plate and the riser or basin, and then make a smooth, continuous fillet around the seam.

- Make sure there are no voids in the adhesive fillet.

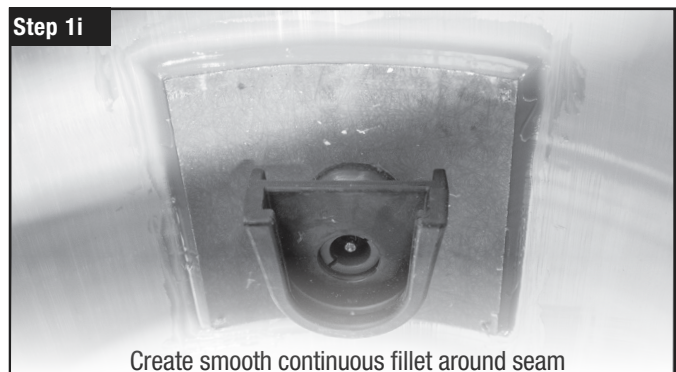
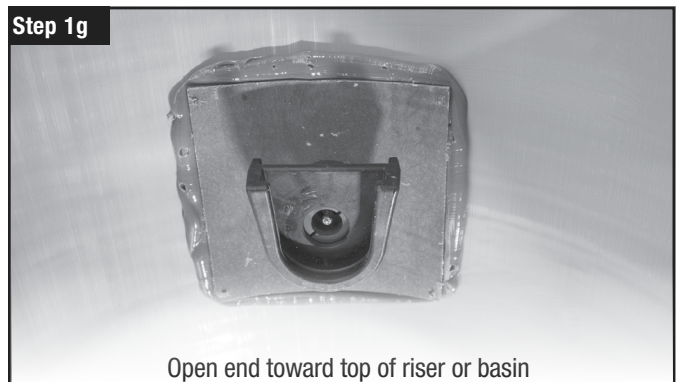
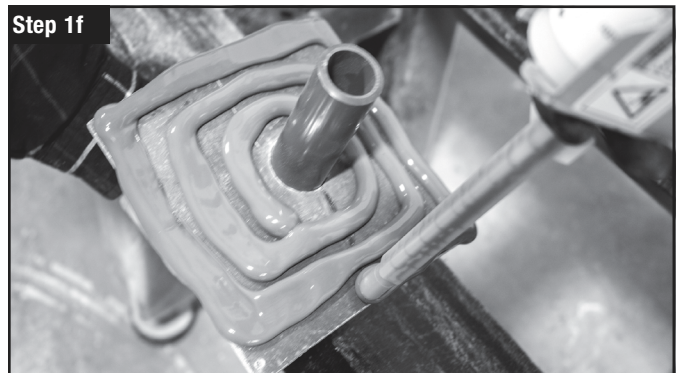
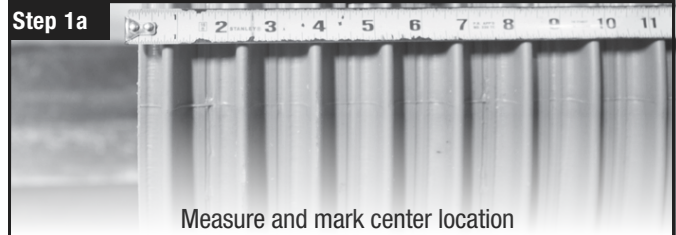

Step 2. Install Tank Adapter (If Needed) and Riser

This step applies only to installations in access risers.

Step 2a. Install the tank adapter if it hasn't been installed. Follow the manufacturer's instructions.

For Orenco tank adapters:

- PRTA24 or PRTA30, see [NIN-TA-PRTA-2, PRTA24 and PRTA30 Tank Adapter Installation](#).
- For RRFTA or RRFTA30, see [NIN-TA-RRFTA-1, RRFTA and RRFTA30 Tank Adapter Installation](#).
- For RFTA24-R PRTA30 with Roth Fralo tanks, see [NIN-RLA-RR-2, Tank Adapter Installation for Roth Tanks](#).

If you don't see your adapter in this list, call the distributor.

Step 2b. Install the access riser and any additional components.

- For installing grommets and attaching access risers to Orenco tank adapters, see [NIN-RLA-RR-1, PVC Riser Installation](#).
- For Orenco external splice boxes, see [NIN-SB-SBEX-1, External Splice Box](#).
- For Orenco internal splice boxes, see [NIN-SB-SB-1, Internal Splice Box](#).
- For Orenco ClickTight, see [NIN-CLK-2, ClickTight Installation Instructions](#).



Key Points

- Watertight seams and penetrations are critical for proper performance.
- Before installing the riser, confirm:
 - The riser is at the correct height – the recommended height is 2in (50mm) above final grade.
 - The riser penetration heights are correct for the connections.
 - The riser with the HDA is being installed over the correct tank access hole.
 - All riser penetrations are aligned correctly.
- After installing the risers, make sure that all adhesive seams are free of voids, with smooth, continuous fillets.
- Do not test watertightness or backfill until the adhesive is set.

Step 3. Test for Watertightness

Step 3a. Test the tank (and tank-to-riser connections) or basin for watertightness. Follow the manufacturer's instructions.

- Some manufacturers require a partial or full backfill around the tank or basin before testing watertightness.
- Use [NIN-RLA-RR-1, PVC Riser Installation](#), to test the seams between the access riser, tank adapter, and tank for watertightness.
- Use [NIN-PB-1, PVC Basin Installation Instructions](#), for testing pump basin watertightness.



Step 5a

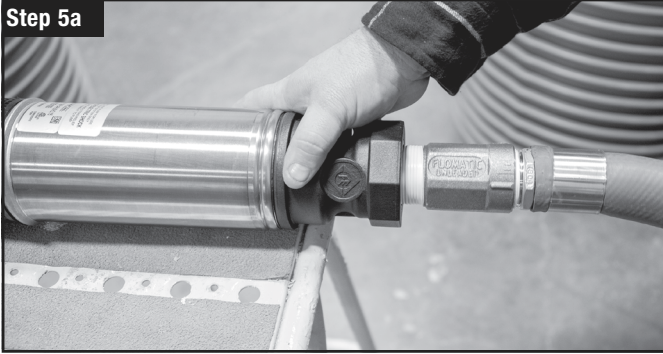

Step 5c



Step 5d

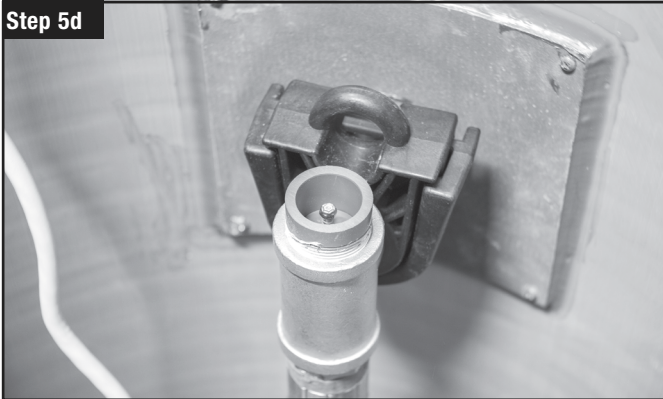

Step 3. Test for Watertightness, cont.



Key Points

- The seams between the access riser, tank adapter, and tank must all pass the watertightness test before you continue.
- Follow all applicable regulations for watertightness testing.

Step 4. Complete Tank or Basin Installation (If Needed)

Complete the septic tank or basin installation, if needed. Follow the manufacturer's instructions.

- For Orenco M-series tanks, see [NIN-TNK-9, M-Series Tank Burial](#).
- For Orenco pump basins, see [NIN-PB-1, PVC Basin Installation Instructions](#).

Step 5. Prep and Install 4in (100mm) Pump Assembly

Step 5a. Screw the discharge hose into the pump's discharge end.

- Prep the threads with thread seal tape or thread lubricant.



IMPORTANT — DO NOT raise or lower the pump assembly by the power cord! This can damage the pump and void the pump warranty.

Step 5b. Make sure the pump vault is installed in the tank or basin.

- For PVP-series vaults, see [NIN-PVU-3, PVP-Series Biotube Pump Vault Installation Instructions](#).
- For PVU-series vaults, see [NIN-PVU-1, Biotube Pump Vault Installation Instructions](#).

Step 5c. Carefully lower the pump assembly into the pump vault's flow inducer.

Step 5d. Slide the quick-disconnect on the pump assembly into the quick disconnect on the mounting plate assembly.

- Make sure the pump assembly quick-disconnect is fully and firmly seated into the mounting plate assembly quick disconnect.

Step 5e. If the pump cord is not being routed and wired immediately, stow the cord in the riser or basin.

- For internal splice boxes, coil the power cord and place it neatly around the splice box.
- For external splice boxes, coil the power cord and secure it to the riser wall with the hook-and-loop strip.
- For ClickTight, coil the power cord and secure it to the riser wall with the hook-and-loop strip.