

# PFSW-Series Submersible Sewage Pumps

## Applications

PFSW-Series Submersible Sewage Pumps are typically used to transport sewage, including solids up to 2in (51mm) in diameter, from pump basins to primary tankage. Their corrosion-resistant construction makes them highly durable in wastewater applications. The PFSW50XX-B and PFSW15012 are CSA and UL listed; the PFSW10012 is CSA listed only. Manufactured by Franklin Electric.



PFSW50XX-B



Powered by  
**Franklin Electric**

## General

To specify this product, require the following:

- Can handle sewage, including solids up to 2in (51mm) in diameter
- Cast iron pump housing and cover
- Oil-filled motor housing for lifetime lubrication and rapid heat dissipation
- Stainless steel screws, bolts, and handle
- Mechanical shaft seals made of corrosion-resistant materials including carbon/ceramic
- Three-year warranty from date of manufacture

## Standard Models

PFSW5011-B, PFSW5012-B, PFSW10012-B, PFSW15012

(Additional configurations available.)

## Product Code Diagram

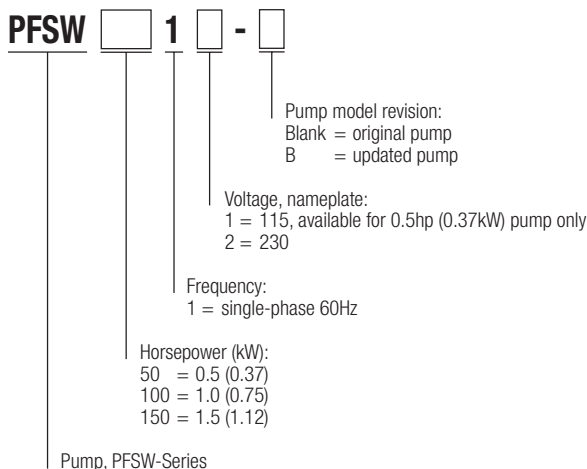

*Not all product code configurations may be available as standard products.*

## Materials of Construction

	PFSW50XX-B	PFSW10012	PFSW15012
Motor housing	Cast iron	Cast iron	Epoxy-coated cast iron
Impeller	Cast iron	Cast iron	Red brass
Volute	Cast iron	Cast iron	Epoxy-coated cast iron
Power cord	16/3, STW	16/3, STW	14/3, SOW
Mechanical shaft seal	Carbon/ceramic	Carbon/ceramic	Carbon/ceramic
Bearings	Ball	Ball	Ball
Shaft	Stainless steel	Stainless steel	Stainless steel
Fasteners	Stainless steel	Stainless steel	Stainless steel

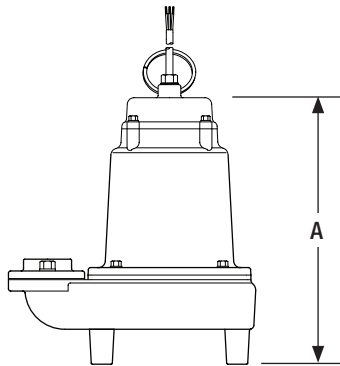

PFSW5011-B (side view)

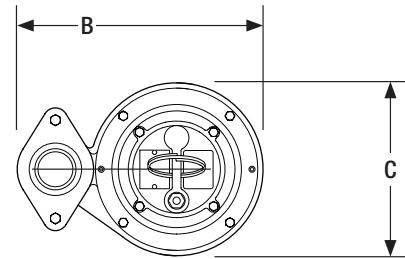

PFSW5011-B (top view)

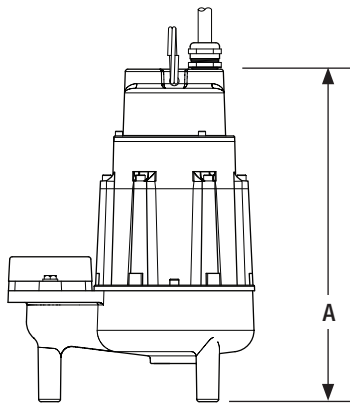

PFSW15012 (side view)

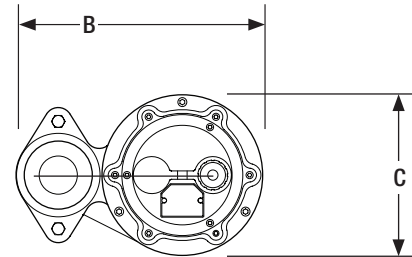

PFSW15012 (top view)

## Specifications

Dimensions, in (mm)	PFSW5011-B	PFSW5012-B	PFSW10012	PFSW15012
<b>A</b>	16.15 (410)	15.1 (384)	15.1 (384)	18.4 (467)
<b>B</b>	14.07 (357)	12.25 (311)	12.25 (311)	13 (330)
<b>C</b>	9.89 (251)	9.38 (238)	9.38 (238)	8.4 (213)
Discharge size*	2in	2in	2in	3in
Cord length, ft (m)	20 (6.1)	30 (9.1)	20 (6.1)	20 (6.1)
Weight, lb (kg)	85 (38.6)	60 (27.2)	62 (28.1)	96 (43.5)

## Performance

Horsepower (kW)	0.5 (0.37)	0.5 (0.37)	1.0 (0.75)	1.5 (1.12)
Nameplate voltage	115	230	230	230
Full load amps	11.6	9.7	10.7	15.5
Minimum liquid level, in (mm)	16.2 (411)	15.1 (384)	15.1 (384)	18.4 (467)
Impeller type	Non-clog	Non-clog	Non-clog	Non-clog

\* Discharge is NPT threaded receptacle-style port, US nominal size, to accommodate Orenco discharge hose and valve assemblies. Consult your Orenco distributor about fittings to connect discharge assemblies to metric-sized piping.

## Using a Pump Curve

A pump curve helps you determine the best pump for your system. Pump curves show the relationship between flow (gpm or L/sec) and pressure (total dynamic head, or TDH), providing a graphical representation of a pump's optimal performance range. At low flow rates, TDH varies from pump to pump, so it is represented as a dashed line in the pump curves. For the most accurate pump specification, use Orenco's PumpSelect™ software.

