

Stormwater Catch Basin

Applications

Orenco's Stormwater Catch Basin (SCB) is a cost-effective alternative to concrete or steel catch basins. It is ideal for jurisdictions that require filtration of stormwater before it is released on-site or to a stormwater collection system. It is also well suited for use in rainwater collection systems. The SCB is designed to screen materials as small as 1/8in (3mm) diameter out of stormwater.

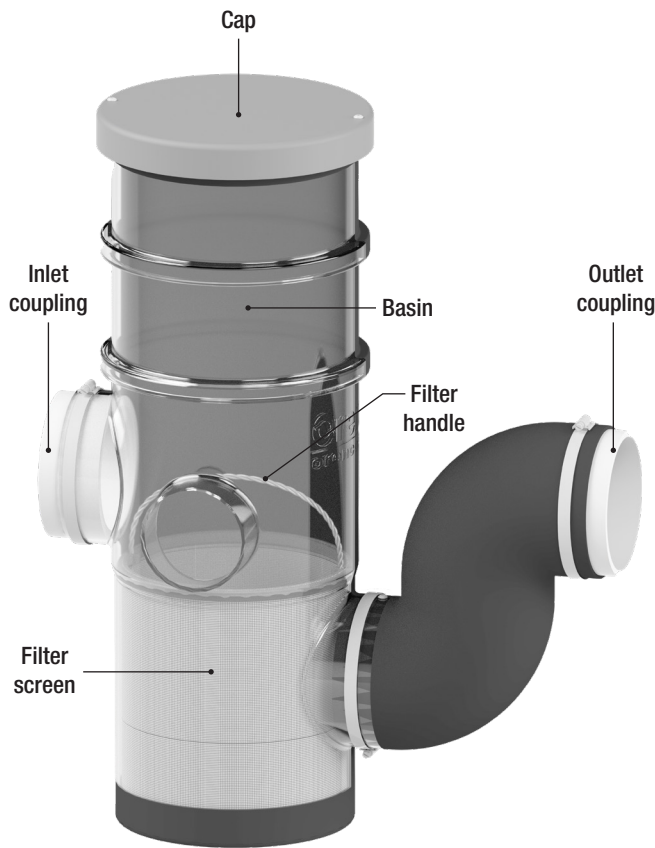

SCB1236-6L Stormwater Catch Basin (transparent to show components)

General

Orenco's Stormwater Catch Basin (SCB) is based on Orenco's proven Screened Pump Vault technology and materials.

Stormwater flows through the inlet and into the basin vault, where it is screened through the 1/8in (3mm) filter mesh before flowing out through the basin outlet. The filter has a nominal open area of 50%. It is designed for easy removal and cleaning, to simplify maintenance.

All SCBs use durable Orenco ASA caps. SCBs have a height of 36in (914mm), but can be cut down to heights of 30in (762mm) or 24in (610mm). The inlet and outlet couplings on the SCB1236-6L accommodate 6in iron pipe size (IPS) pipe; the inlet and outlet couplings on all other models accommodate 4in IPS pipe.

Standard Models

SCB1236, SCB1236-L, SCB1236-6L

Product Code Diagram

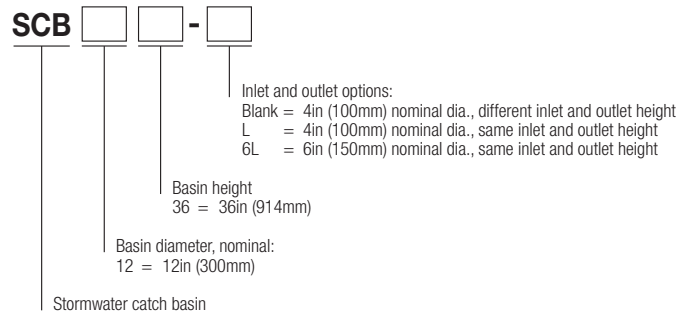

Materials of Construction

Basin	Polyethylene
Cap	Acrylonitrile styrene acrylate (ASA)
Couplings, inlet and outlet	Schedule 40 PVC
Filter ring and base	DCPD
Filter screen	Polyethylene
Outlet, 4in (100mm)	Schedule 40 PVC
Outlet, 6in (150mm)	Polyethylene

Specifications

Dimensions, in (mm)

	SCB1236	SCB1236-L	SCB1236-6L
A	18-7/8 (479)	27-11/16 (703)	29-1/16 (738)
B	36 (914)	36 (914)	36 (914)
C	4-1/2 (114)	4-1/2 (114)	6-5/8 (168)
D	14-1/8 (359)	14-1/8 (359)	14-3/16 (360)
E	4-1/2 (114)	4-1/2 (114)	6-5/8 (168)
F	4-5/8 (117)	14-1/8 (359)	14-3/16 (360)
G	13 (330)	13 (330)	13 (330)

Flow rates, gpm (L/sec)

	SCB1236	SCB1236-L	SCB1236-6L
Top of inlet	130 (8.2)	40 (2.5)	115 (7.3)
+ 4in (102mm)	170 (10.7)	n/a	n/a
+ 6in (152mm)	n/a	100 (6.3)	190 (12.0)
+ 12in (305mm)	n/a	140 (8.8)	n/a

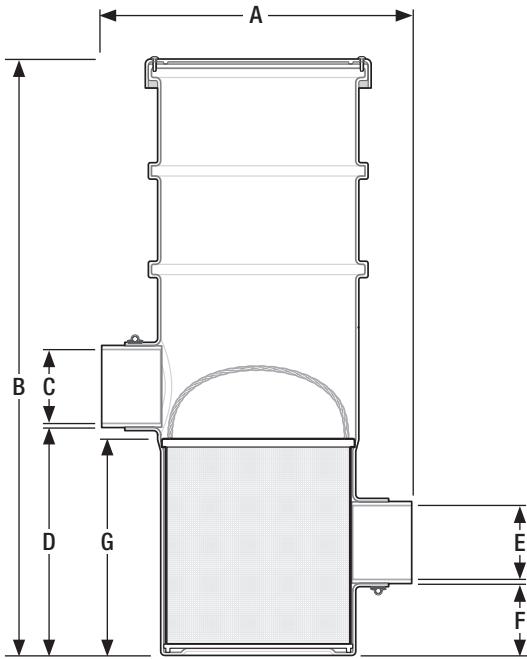

SCB1236

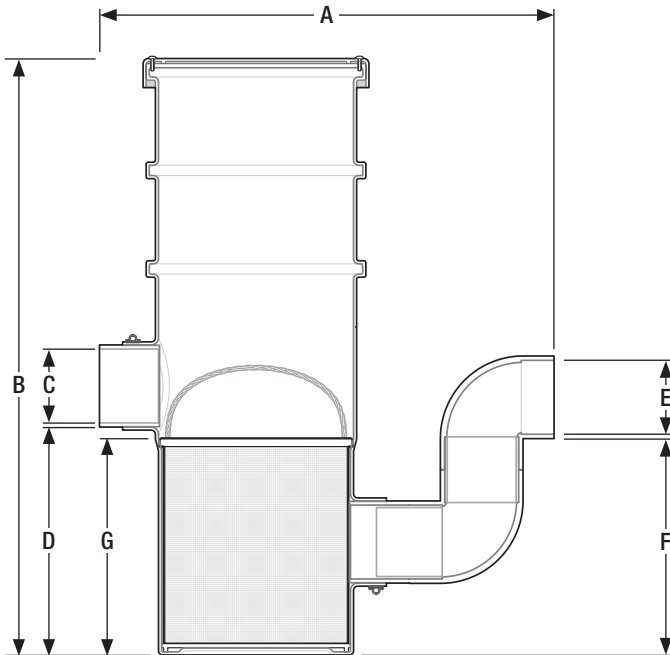

SCB1236-L

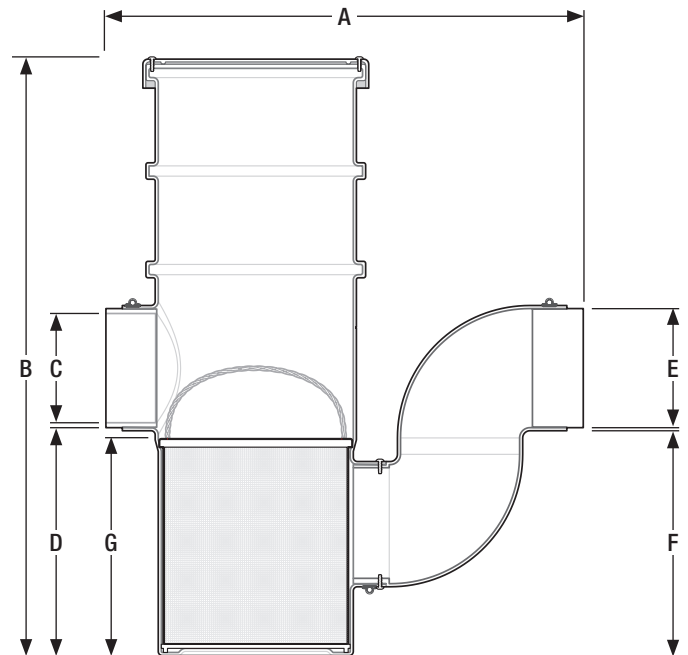

SCB1236-6L