

Adapters for Roth Tanks



IMPORTANT — Orenco strongly recommends watertightness testing of all access riser-to-tank connections after installation.

24in (600mm) Adapter Installation

Orenco's FRTA24-RVF tank adapter requires the FRTA24-RBDKIT bolt-down kit, which contains screws and a sealant tape gasket for securing the adapter to tanks manufactured by Roth North America.

Step 1. Drill Pilot Holes

Step 1a. Center the adapter in the tank opening.

Step 1b. Use the eight predrilled holes in the adapter as guides to drill 1/4in (6.35mm) pilot holes through the tank.



Key Point — Be careful not to widen the holes in the adapter.

Step 1c. Remove the adapter and set it aside.

Step 2. Clean Tank Opening and Apply Sealant

Step 2a. Wipe the tank opening with a clean cloth and acetone.

Step 2b. Apply a ring of the sealant tape gasket around the tank opening against the lip of the tank opening, inside the circle of pilot holes.

- Abut the ends of the tape together.

Step 3. Secure Tank Adapter

Step 3a. Remove the protective strip from the sealant tape gasket.

Step 3b. Place two screws in the adapter to use as guides to find the pilot holes.

Step 3c. Set the adapter in place onto the gasket using the screws to align the pilot holes.

Step 3d. Carefully drive all of the screws into the tank just until they are almost fully inserted, then stop.

Step 3e. Tighten the screws in an alternating pattern around the adapter until all are snug.



Note — If a screw begins to strip, stop tightening it. This won't harm the threads if the screw isn't tightened further.

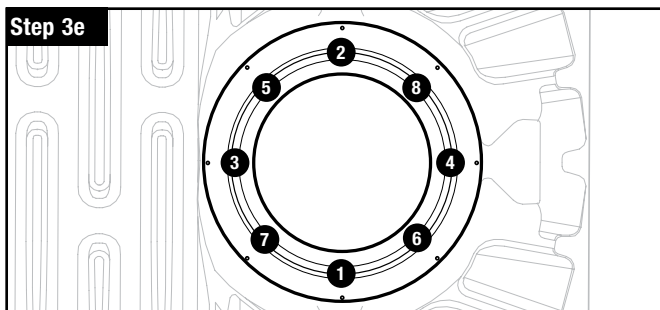
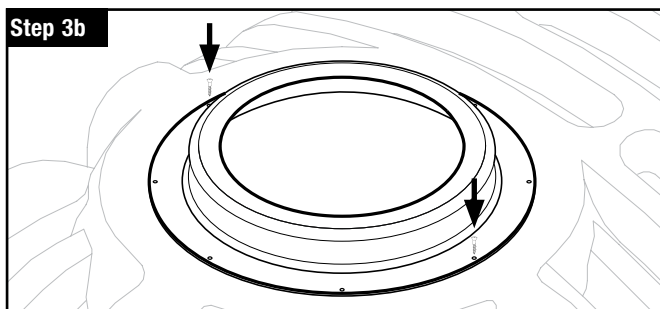
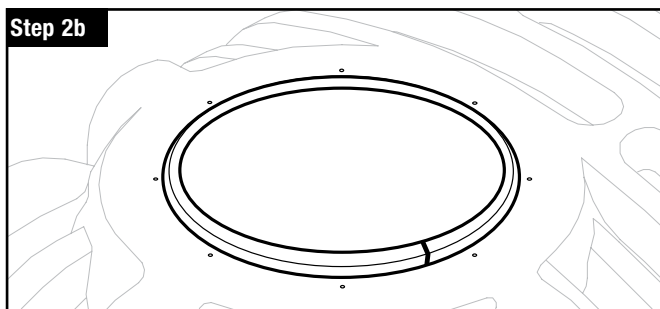
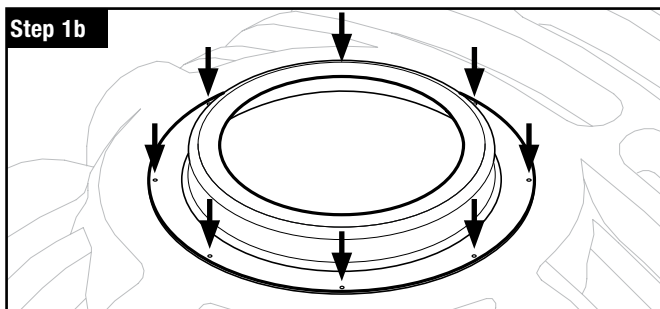

30in (750mm) Adapter Installation

Orenco's PRTA30 tank adapter requires the PRTA30-RBDKIT bolt-down kit, which contains screws and a sealant tape gasket for securing the adapter to tanks manufactured by Roth North America.

Step 1. Clean Tank Opening and Apply Sealant

Step 1a. Wipe around the tank opening with a clean cloth and acetone.

Step 1b. Apply a ring of the sealant tape gasket around the tank opening as shown (at the inside lip of the outer ring).

- Abut the ends of the tape together.

Step 2. Secure Tank Adapter

Step 2a. Remove the protective strip from the sealant tape gasket; then carefully center the adapter over the tank opening and place it on the butyl tape.

Step 2b. Carefully drive all of the screws into the tank just until they are almost fully inserted, then stop.

Step 2c. Tighten the screws in an alternating pattern around the adapter until all are snug.

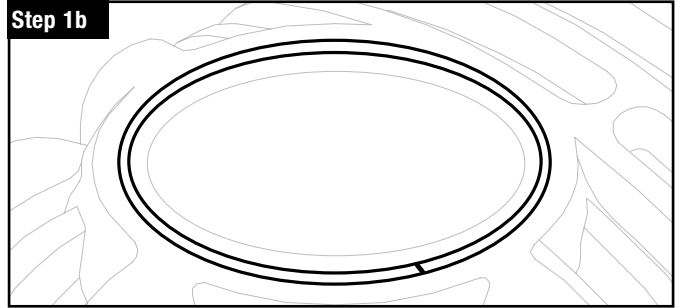
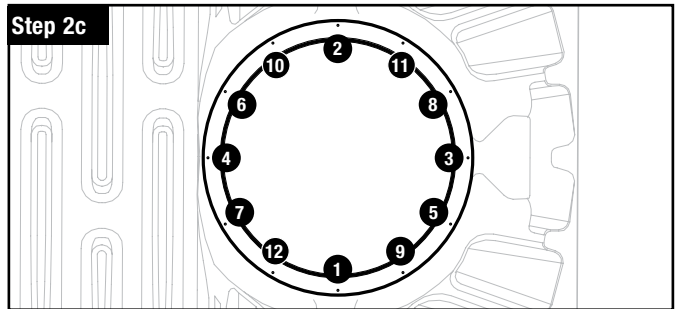
Step 1b**Step 2c**

Note — If a screw begins to strip, stop tightening it. This won't harm the threads if the screw isn't tightened further.

Installing a Riser onto a Tank Adapter

See [PVC Riser Installation Instructions, NIN-RLA-RR-1](#) for instructions on installing the riser onto the tank adapter and testing for watertightness.